

FORMER SUPER KMART BUILDING & LAND

LOCATED IN A PREMIER U.S. LABOR MARKET

LOCATION DETAILS

**2375 WEST 32ND STREET :: YUMA, ARIZONA
FOR LEASE OR SALE**

- 191,008 sq. ft.
- 21.63 Acres
- 6.20 : 1,000 parking ratio
- Zoned General Commercial (B-2)



FOR MORE INFORMATION CONTACT:

Gary Magrino

Business Development Director

Cocopah Indian Tribe

(928) 722-7540

magrinog@cocopah.com

Cocopah Indian Tribe | 14515 South Veterans Drive | Somerton, AZ 85350 | www.cocopah.com

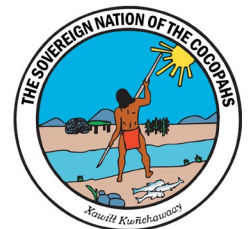

FORMER SUPER K MART BUILDING & LAND

LOCATED IN A PREMIER U.S. LABOR MARKET
 NOW AVAILABLE :: 2375 WEST 32ND STREET :: YUMA, AZ

2015 Estimated Demographics	Within 15 miles	Within 25 miles
Population	194,309	198,423
Labor Statistics		
Year Round Labor Force		90,000
Dec. 2014 Unemployment Rate		16.1%
Traffic Counts		
2014 RAW Average Traffic Counts		35,510

Source: Greater Yuma Economic Development Corporation

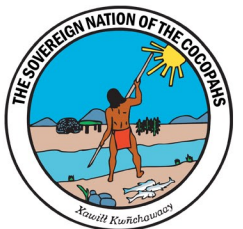
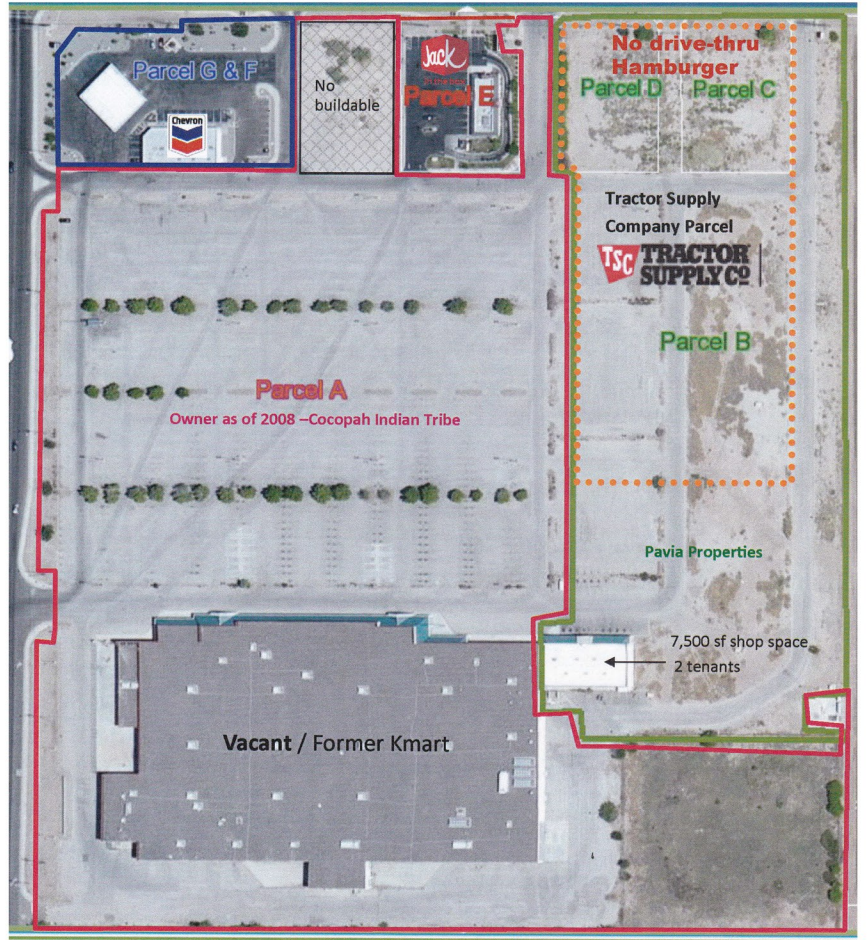



Southeast Corner of 32nd St. & Hwy 95 (Ave. B)

FOR MORE INFORMATION CONTACT:

Gary Magrino

Business Development Manager
Cocopah Indian Tribe
(928) 722-7540
magrinog@cocopah.com

